

→ Connecting bush

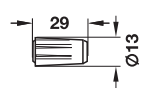

• Material: Plastic	
• Installation: For press fitting into railing tubes	
Colour	Cat. No.
White	521.16.006
Packing: 1 piece	

→ Tube support

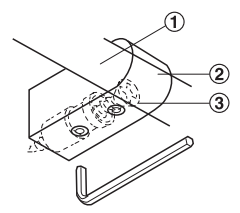
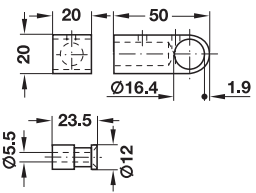
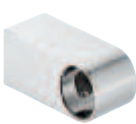

- ① Tube
- ② Tube support
- ③ Hexagon socket SW2.5

• Material: Zinc alloy	
Finish	Cat. No.
Chrome plated matt	521.16.453
Chrome plated polished	521.16.257
Packing: 1 piece	

→ Tube support

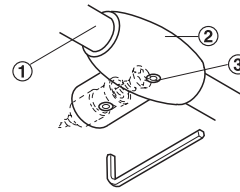
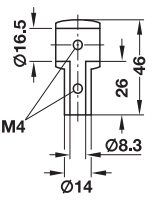

- ① Tube
- ② Tube support
- ③ Hexagon socket screw M4, SW2.5

• Material: Zinc alloy	
Finish	Cat. No.
Nickel plated matt	522.02.614
Chrome plated polished	522.02.212
Packing: 1 piece	

→ Adaptor

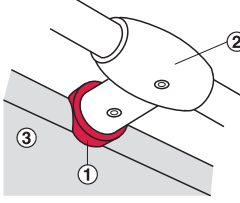
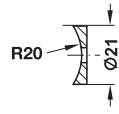

- ① Adaptor
- ② Tube support
- ③ Worktop

• Area of application: For tube supports, for compensation with rounded worktops	
• Material: Zinc alloy	
Finish	Cat. No.
Nickel plated matt	522.02.687
Chrome plated polished	522.02.285
Packing: 1 piece	

→ Hooks

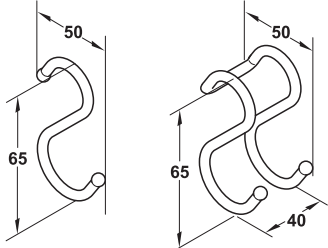

• Material: Steel		
Version	Finish	Cat. No.
Single hook	Chrome plated matt	521.20.411
	Chrome plated polished	521.20.215
Double hooks	Chrome plated matt	521.20.420
	Chrome plated polished	521.20.224
Packing: 1 piece		

DPH-M-INT 2013, HDE-en, 01/13; Dimensional data not binding. We reserve the right to alter specifications without notice.



→ Cook book shelf, collapsible

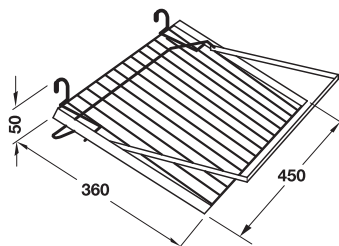

• Material: Steel

Finish	Cat. No.
Chrome plated matt	521.19.445
Chrome plated polished	521.19.249

Packing: 1 piece

→ Shelf

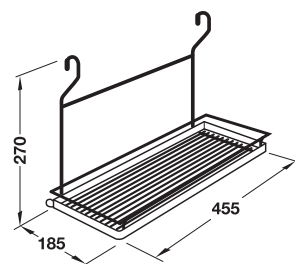

• Material: Steel

Finish	Cat. No.
Chrome plated matt	521.19.463
Chrome plated polished	521.19.267

Packing: 1 piece

→ Cutlery holder with 1 beaker

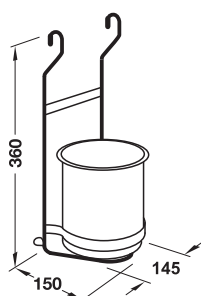

• Material: Steel, beaker: Stainless steel

Finish	Cat. No.
Chrome plated matt	521.19.511
Chrome plated polished	521.19.311

Packing: 1 piece

→ Spice rack, 2 tiers

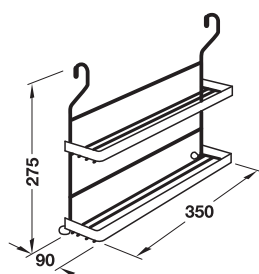

• Material: Steel

Finish	Cat. No.
Chrome plated matt	521.19.427
Chrome plated polished	521.19.221

Packing: 1 piece

→ Kitchen roll holder

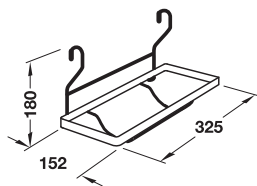
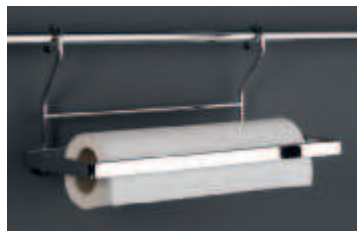

- Material: Steel

Finish	Cat. No.
Chrome plated matt	521.19.534
Chrome plated polished	521.19.338

Packing: 1 piece

→ Kitchen roll holder, 3 tiers, with tear off edge for aluminium foil and cling film

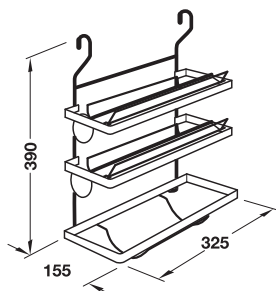

- Area of application: For kitchen roll, aluminium foil and cling film
- Material: Steel

Application



Pull out cling film and tear off at edge that unfolds automatically.

Finish	Cat. No.
Chrome plated matt	521.19.431
Chrome plated polished	521.19.231

Packing: 1 piece

→ Hand mixer holder with hooks for beaters

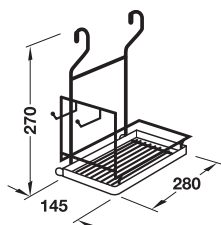

- Material: Steel

Finish	Cat. No.
Chrome plated matt	521.19.472
Chrome plated polished	521.19.276

Packing: 1 piece

→ Knife rack with knife block and hooks

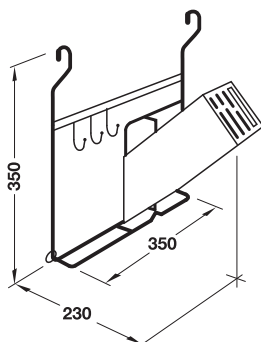
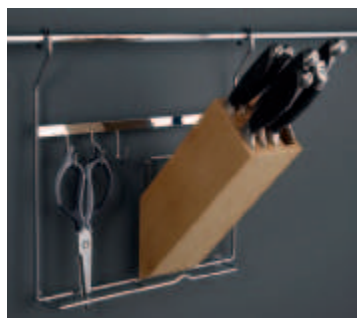

- Material: Steel, knife block: Solid beech

Note

Knife block can be removed from the rack for easier cleaning

Finish	Cat. No.
Chrome plated matt, knife block matt lacquered	521.19.409
Chrome plated polished, knife block matt lacquered	521.19.203

Packing: 1 piece

Railing system with grooved profile



Profile strip with kitchen roll holder, 3 tiers

- Version: Components can be individually positioned, concealed component fixing, grooved profile strip lies directly against the wall

A

Stainless steel effect:

- Support elements: Steel, nickel plated matt
- Shelves and functional plates, beakers, covers: Stainless steel bright
- End cap and connector: Plastic, nickel plated matt

→ Grooved profile strip



6

Midway Systems



Installation



- Material: Grooved profile strip: Plastic, cover: Stainless steel, end cap and connector: Plastic
- Finish: Grooved profile strip, end cap and connector: Nickel plated matt, cover: Bright

Supplied with

- 1 Grooved profile strip
- 2 End caps
- 1 Connector
- 1 Cover
- 1 Set of fixing material

Length mm	Cat. No.
600	521.60.606
900	521.60.609
1200	521.60.612
1500	521.60.615

Packing: 1 set

→ Tea towel rail

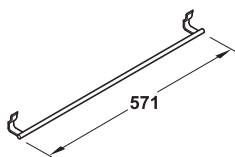

Finish	Cat. No.
Stainless steel effect	521.61.601

Packing: 1 piece

→ Hook rail with 6 hooks

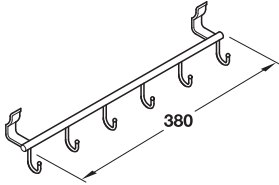

Finish	Cat. No.
Stainless steel effect	521.61.600

Packing: 1 piece

→ Shelf

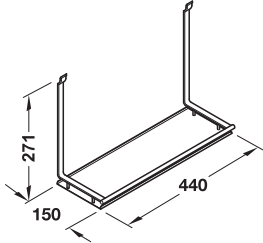

Finish	Cat. No.
Stainless steel effect	521.61.620

Packing: 1 piece

→ Cook book shelf, collapsible

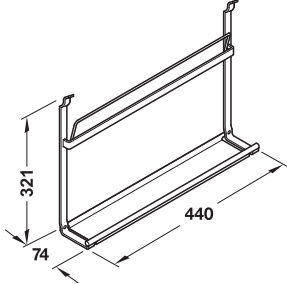

Finish	Cat. No.
Stainless steel effect	521.61.627

Packing: 1 piece

→ Writing set holder with note pad and 2 ballpoint pens

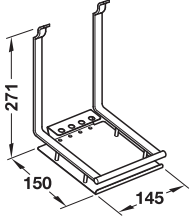

Finish	Cat. No.
Stainless steel effect	521.61.638

Packing: 1 piece

→ Lid rack

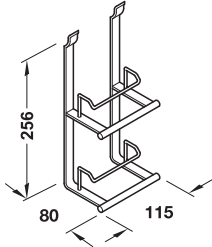

Finish	Cat. No.
Stainless steel effect	521.61.630

Packing: 1 piece

→ Cutlery holder with 1 beaker

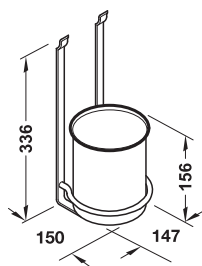

- Diameter: Internal: 125 mm, external top: 145 mm, external bottom: 127 mm

Finish	Cat. No.
Stainless steel effect	521.61.635

Packing: 1 piece

→ Cutlery holder with 3 beakers (removable)

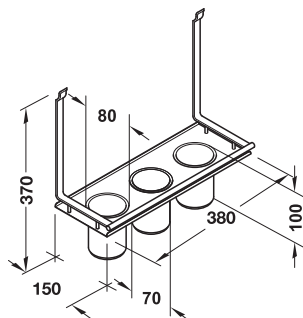

Finish	Cat. No.
Stainless steel effect	521.61.635

Packing: 1 piece



6

Midway Systems

→ Knife block with wooden block

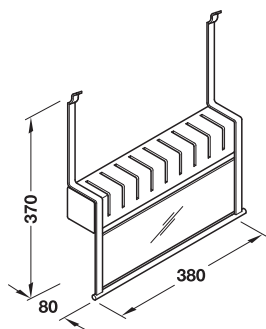

- Material: Support element: Steel, cover: Acrylic glass, wooden block: Solid beech

Finish	Cat. No.
Stainless steel effect	521.61.633

Packing: 1 piece

→ Kitchen roll holder

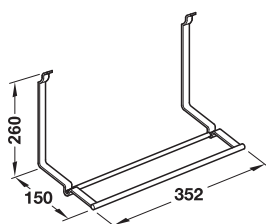

Finish	Cat. No.
Stainless steel effect	521.61.611

Packing: 1 piece

→ Kitchen roll holder, 3 tiers, with tear off edge for aluminium foil and cling film

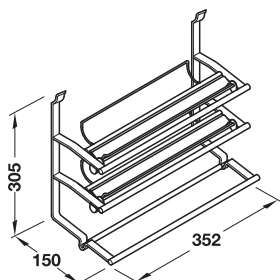
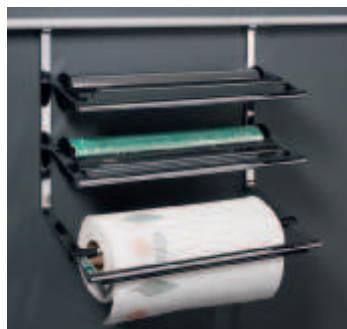

- Area of application: For kitchen roll, aluminium foil and cling film

Finish	Cat. No.
Stainless steel effect	521.61.610

Packing: 1 piece

Functionality ► FF 6.63

→ **Plate and chopping board rack**

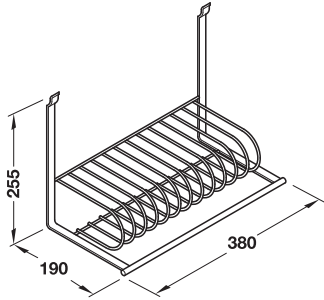

- Area of application: For 12 plates, plate Ø ≤250 mm, plate height ≤23 mm

Finish	Cat. No.
Stainless steel effect	521.61.632

Packing: 1 piece

→ **Utensil rack**

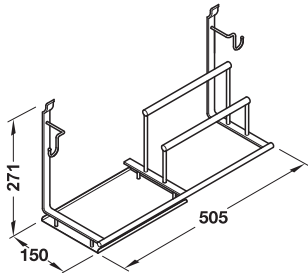

Finish	Cat. No.
Stainless steel effect	521.61.639

Packing: 1 piece

→ **Place setting holder with 1 beaker**

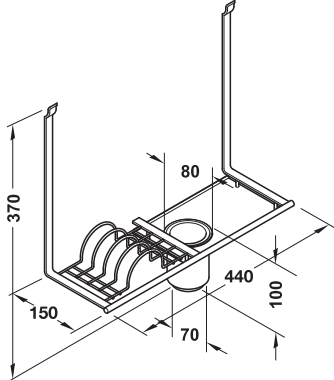

Finish	Cat. No.
Stainless steel effect	521.61.637

Packing: 1 piece

→ **Spice rack, 2 tiers**

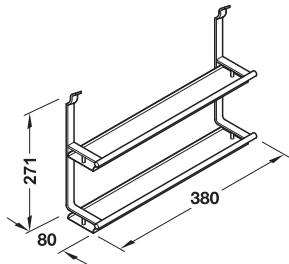

- Area of application: For containers up to Ø 59 mm and 110 mm in height

Finish	Cat. No.
Stainless steel effect	521.61.625

Packing: 1 piece

Shelf suspension system with wire cable

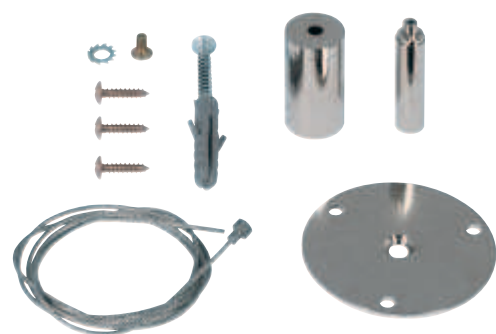

- Area of application: For hanging wooden shelves
- Material: Steel, cable: Stainless steel
- Finish: Chrome plated
- Load bearing capacity: 20 kg per cable with DIN-compliant installation
- Length: Cable 1,000 mm
- Diameter: Cable 1.5 mm
- Installation: For screw fixing
- Version: Cable can be shortened

Installation

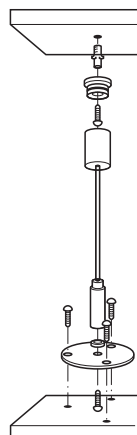

Supplied with

- 1 Cable with 2 cover sleeves
- 1 Set of mounting material for one cable
- 1 Set of installation instructions

Area of application	Cat. No.
For hanging wooden shelves	828.55.220

Packing: 1 set

Breakfast bar support For glue fixing



- Material: Aluminium
- Finish: Matt
- Load bearing capacity: 15 kg, with 600 mm clearance and 200 mm projection (overlap)
- With fixing material for worktop attachment

Installation	Cat. No.
For glue fixing	505.19.400

Packing: 1 or 20 pieces

Application and planning dimensions

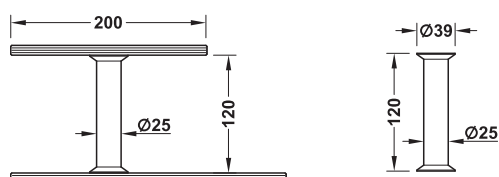

For mounting on worktops or furniture

→ Straight, round



- Material: Steel
- Load bearing capacity: 15 kg, with 600 mm clearance and 200 mm projection (overlap)
- Supplied with: Fixing material

Application and planning dimensions

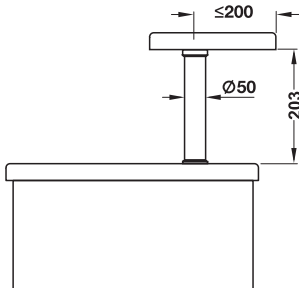

Note

Installation “for glue fixing” only applies to the top connection, the bottom connection is always screwed.

Installation	Chrome plated matt	Chrome plated polished	Nickel plated matt
For screw fixing	505.15.400	505.15.200	505.15.600
For glue fixing	505.15.401	505.15.201	505.15.601

Packing: 1 piece

→ Inclined, round



- Material: Steel
- Load bearing capacity: 15 kg, with 600 mm clearance and 200 mm projection (overlap)
- Supplied with: Fixing material and installation instructions

Application and planning dimensions

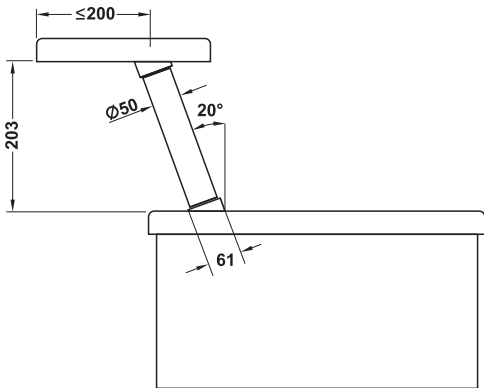

Note

Installation “for glue fixing” only applies to the top connection, the bottom connection is always screwed.

Installation	Chrome plated polished	Chrome plated matt	Nickel plated matt
For screw fixing	505.15.210	505.15.410	505.15.610
For glue fixing	505.15.211	505.15.411	505.15.611

Packing: 1 piece

Glass gluing technique

► FF 13.5



6

Midway Systems

→ Straight, square

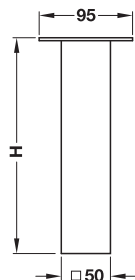

- Material: Aluminium / steel
- Load bearing capacity: 25 kg
- Installation: For screw fixing
- Supplied with: Fixing material

Finish	Height H mm	Cat. No.
Stainless steel effect	170	505.21.011
	220	505.21.013

Packing: 1 piece

→ Inclined, square

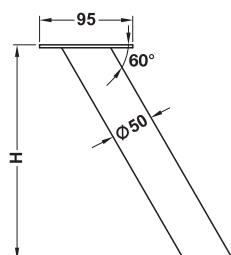

- Material: Aluminium / steel
- Load bearing capacity: 20 kg
- Installation: For screw fixing
- Supplied with: Fixing material

Finish	Height H mm	Cat. No.
Stainless steel effect	170	505.21.031
	220	505.21.033

Packing: 1 piece

Glass adapter for glue fixing

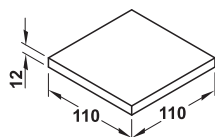

- Area of application: For straight and inclined, square breakfast bar supports

Material	Finish	Cat. No.
Aluminium	Silver coloured anodized	505.21.990

Packing: 1 piece

Table leg

► FF 11.28

→ Inclined, Z shape

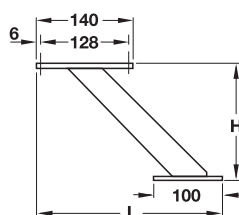

- Material: Aluminium
- Finish: Silver coloured matt, anodized E6/EV1
- Load bearing capacity: 25 kg
- Installation: For screw fixing
- Supplied with: Fixing material

Length L mm	Height H mm	Cat. No.
270	170	505.14.926
310	210	505.14.936

Packing: 1 piece



6

Midway Systems



Ironfix Ironing board



For application in hotels, motels, guest houses or holiday homes



Possible covers:



Aluminium

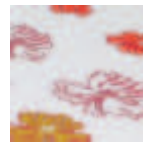

Flowers

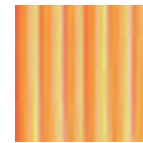

Multicoloured
stripes

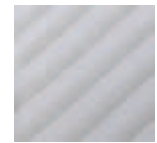

Grey stripes

The aluminium cover is extremely durable and has excellent gliding properties due to its heat-reflecting double aluminium coating. Ironing board covers with 2 mm foamback.

Type overview

①

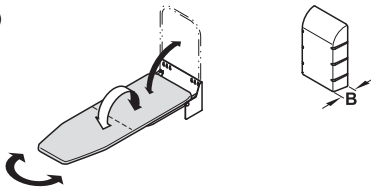

B = projection with covering hood 140 mm

Wall mounted (collapsible)

This version can be found on page FF 6.72.

- Compact design for mounting to the wall
- Can be positioned at any height
- Rotates to the left and right

②

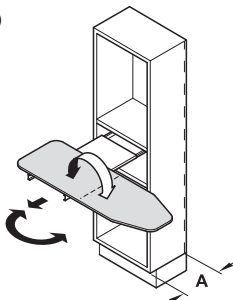

A = internal cabinet depth >350 mm

Shelf mounted (without front connection)

This version can be found on page FF 6.72.

- Rotates in front of the cabinet
- Low installation depth for narrow furniture

③

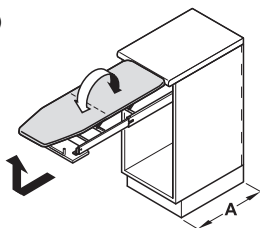

A = internal cabinet depth >500 mm

Behind drawer front panel

This version can be found on page FF 6.73.

- The ironing board is raised to worktop height when extended
- It automatically disappears behind a folding drawer front panel when closed
- With facility for hooking in the small ironing board

④

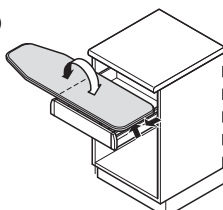

Drawer mounted

This version can be found on page FF 6.74.

- The ironing board is raised to worktop height when extended
- Can be folded down and folded out
- Installed in drawers (retrofitting possible)
- Ideal for use with Moovit drawer side runner system

Ironfix Ironing board

→ Wall mounted

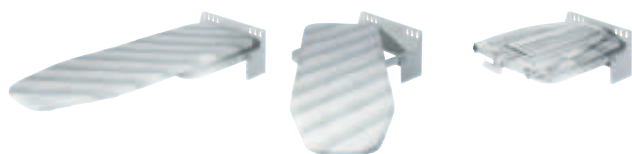

- Material: Fitting parts: Steel
- Finish/colour: Fitting parts: Plastic coated, white, RAL 9016
- Version: Fully pre-assembled, folding, rotates continuously through 180°, with locking facility

For wall mounting

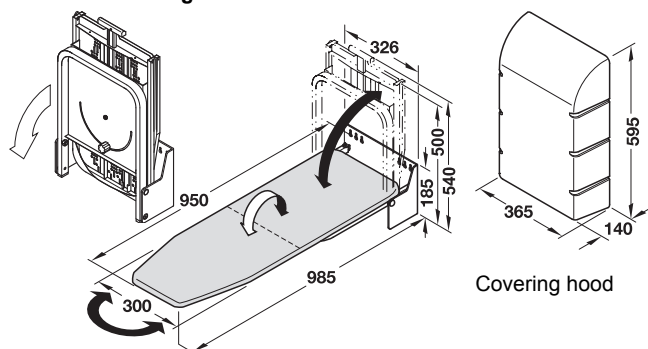

Cover	Cat. No.
Aluminium	568.66.723
Flowers	568.66.722
Multicoloured stripes	568.66.721
Grey stripes	568.66.700

Packing: 1 piece

Covering hood

Material	Colour	Cat. No.
Plastic	White, RAL 9016	568.66.790

Packing: 1 piece



Aluminium



Flowers

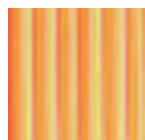

Multicoloured stripes

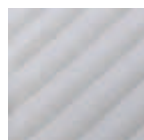

Grey stripes

→ Shelf mounted

Vitaflex

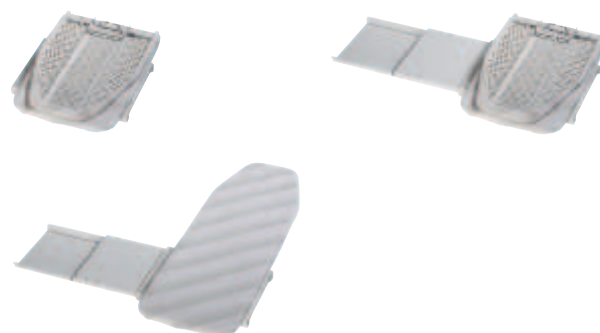

- Material: Fitting parts: Steel
- Finish/colour: Fitting parts: Plastic coated white, RAL 9016
- Version: Collapsible, rotates through 180°, positioning at 15° intervals, completely pre-mounted without front connection
- Installation depth: 350 mm
- Installation height: 125 mm
- Installation width: 520 mm

For shelf mounting

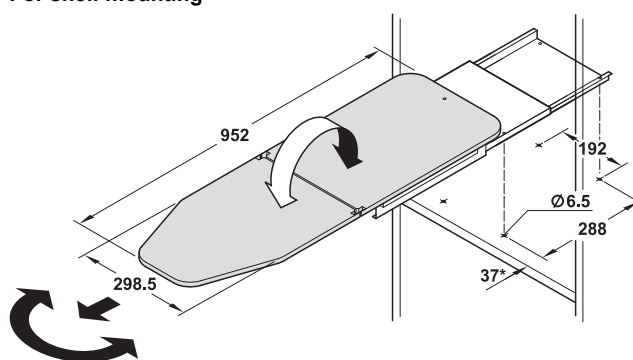

* 40 mm with door/flap

Cover	Cat. No.
Aluminium	568.60.793
Flowers	568.60.792
Multicoloured stripes	568.60.791
Grey stripes	568.60.780

Packing: 1 piece

→ For installation behind drawer front panel



- Material: Fitting parts: Steel
- Finish/colour: Fitting parts: Plastic coated white, RAL 9016
- Version: Collapsible, ironing board supports automatically extend when the drawer is opened, continuous width adjustment

Installation in drawer

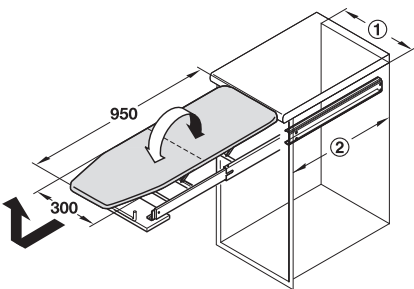

- ① Internal width 362 – 500 mm
- ② Internal cabinet depth >500 mm

Please observe following dimensions in order to mount ironing board flush with worktop:

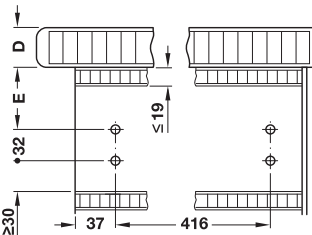

Dim. D mm	20	30	40	50
Dim. E mm	86	76	66	66

Cover	Cat. No.
Aluminium	568.60.723
Flowers	568.60.722
Multicoloured stripes	568.60.721
Grey stripes	568.60.710

Packing: 1 piece

Small ironing board for ironing board installed behind drawer front panel

Vitaflex



- Material: Steel
- Finish/colour: Plastic coated white, RAL 9016
- Installation: For hooking into bracket on ironing board, drawer version

Cover	Small ironing board	Replacement ironing board cover
Aluminium	568.61.726	568.60.933
Grey stripes	568.61.700	568.60.916

Packing: 1 piece

→ Replacement ironing board cover with elasticated fit



Cover	Dim. mm	Cat. No.
Aluminium	1005 x 350 x 2	568.60.923
Flowers		568.60.922
Multicoloured stripes		568.60.921
Grey stripes		568.60.907

Packing: 1 piece



Aluminium



Flowers

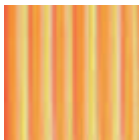

Multicoloured stripes

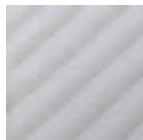

Grey stripes



6

Midway Systems



→ Installation in drawer



- Material: Steel and aluminium
- Finish/colour: Plastic coated, grey
- Version: Collapsible

Installation

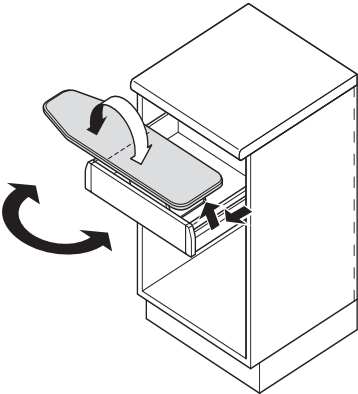

Moovit drawer side runner system

► FF 8.6

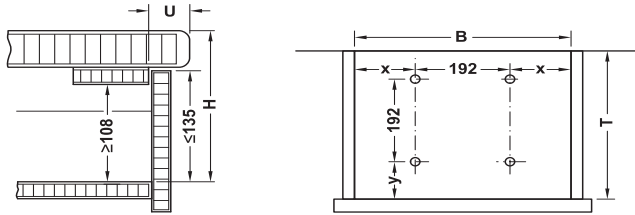

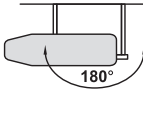
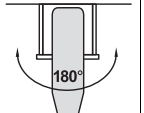
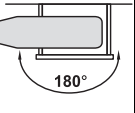
			
Internal drawer width B mm	≥498	≥406	≥506
Internal drawer opening depth T mm	≥435	≥500	≥320
Dim. H mm	—	≤155	≤155
Dim. y mm	≥59	≥150	≥57
Dim. x mm	≥153	≥182/≥32 (left/right)	>277/≥37 (left/right)
Overlay U	≤38	≤25	≤38

When used in combination with
Moovit drawer side runner system

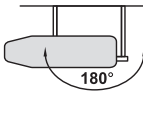
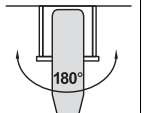
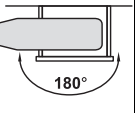
			
Cabinet width mm	600	500	600
Nominal length mm	500	550	400
Drawer side height mm	92 and 115	92	92
Side panel thickness mm	16 and 19	16	16

Cover	Cat. No.
Aluminium	568.60.963
Flowers	568.60.962
Multicoloured stripes	568.60.961
Grey stripes	568.60.964

Packing: 1 piece

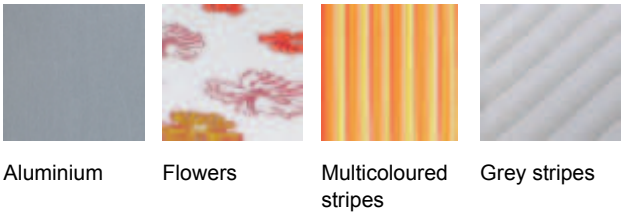

Aluminium

Flowers

Multicoloured
stripes

Grey stripes

Iron and ironing board holder



- Material: Steel
- Finish: Chrome plated
- Installation: For screw fixing
- Supplied with: With 3 fastening blocks

Dim. (W x D x H) mm	Cat. No.
175 x 90 x 300	520.20.701

Packing: 1 piece

Insert mat for cutting to size



A

1 Roll (length 10 m) is sufficient for approx. 19 insert mats (515 x 500 mm)

- Material: Plastic
- Length: 10 m
- Width: 500 mm
- Material thickness: 1.3 mm

Colour	Cat. No.
Napped	
White	547.90.737
Silver coloured	547.90.537
Black	547.90.637
Prisma	
Silver coloured	547.90.957
Anthracite	547.90.357

Packing: 1 piece

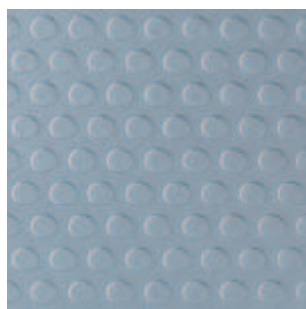

Napped

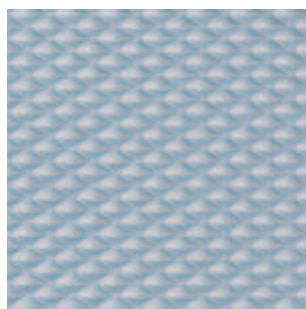

Prisma



White

Silver coloured

Anthracite

Black

Insert mat, pre-cut to size for Moovit

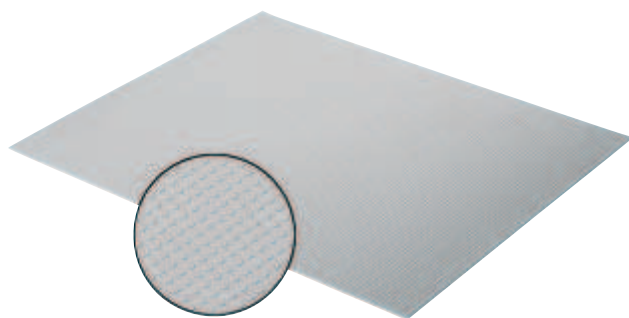

- Area of application: For 19 mm side panel
- Material: Plastic (PS)
- Finish/colour: Napped, silver grey
- For nominal length: 500 mm
- Material thickness: 1.3 mm

For cabinet width mm	Dim. mm	Cat. No.
600	500 x 481	553.68.527
800	700 x 481	553.68.528
900	800 x 481	553.68.529

Packing: 1 piece

Moovit drawer side runner system

► FF 8.6

Insert mat with strips



- Material: Mat: Plastic
- Version: Insert mat with non-slip rubber strips, can be cut to fit any length and width
- Distance: Rubber strips: 50 mm

Finish/colour	Dim. mm	Cat. No.
Mat: Silver coloured grained, rubber strips: Black	510 x 600	547.96.567
	810 x 600	547.96.577
Mat: Maple effect, rubber strips: Silver coloured	510 x 600	547.96.167
	810 x 600	547.96.177
Mat: Wenge effect, rubber strips: Black	510 x 600	547.96.767
	810 x 600	547.96.777

Packing: 1 piece



Silver coloured grained

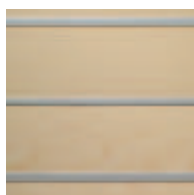

Maple effect

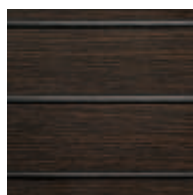

Wenge effect



6

Midway Systems

Wetness protection mat for under-sink unit

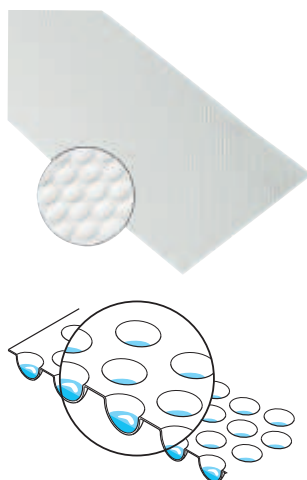
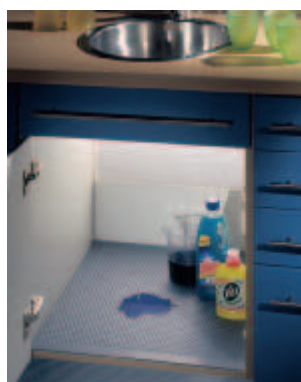

- Material: Plastic (PS)
- Colour: White
- Version: Panels with hemispherical recesses
- Amount of water per m²: 6 litres

Dim. (L x W) mm	Cat. No.
2000 x 580	547.91.704

Packing: 1 piece

Insert tray for under-sink unit

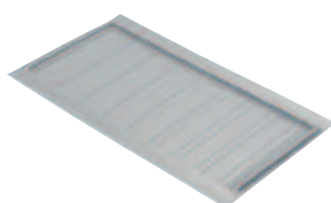
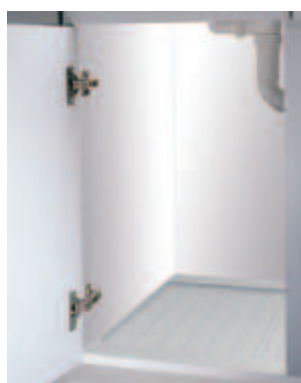

Protects the under-sink unit against damages caused by water outlets

- Material: Plastic (PS)
- Finish/colour: Silver coloured grained
- Material thickness: 1.5 mm
- Depth: 450–580 mm

For cabinet width mm	Width mm	Cat. No.
600	560 – 600	547.99.584
900	860 – 900	547.99.586

Packing: 1 piece

Step stool



- Material: Steel
- Version: With 2 steps 200 x 300 mm and non-slip rubber covered treats, grey/black plastic end caps on all legs

Supplied with
1 Step stool
Operating instructions

Colour	Cat. No.
White/light grey	505.04.704
Silver coloured/black	505.04.210

Packing: 1 piece

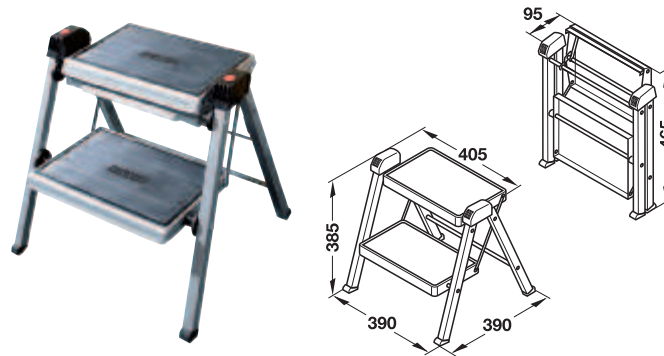

→ **Plinth bracket**
For hooking into step stool

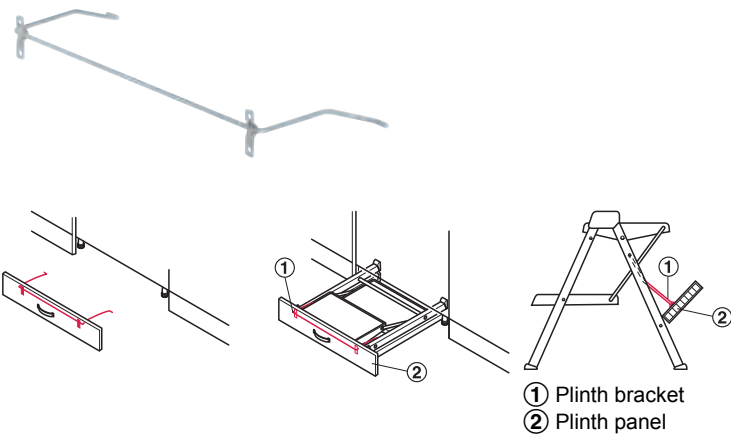

- Material: Steel
- Finish: Galvanized
- Version: With lugs for attaching to plinth panel

	Cat. No.
Plinth bracket for step stool	505.04.419

Packing: 1 or 10 pieces

→ **Bracket**
For step stool

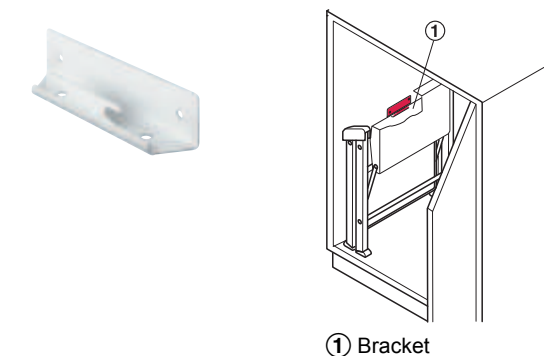

- Material: Steel
- Finish: Plastic coated white
- Installation: For screw fixing

Dim. (W x D x H) mm	Cat. No.
140 x 30 x 30	505.04.722

Packing: 1 or 10 pieces

Step ladder
For plinth area

Vitaflex

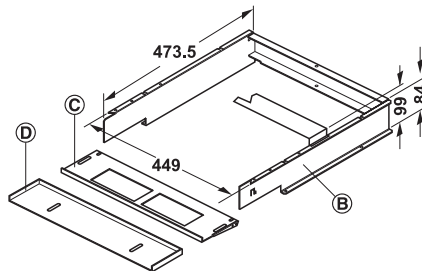
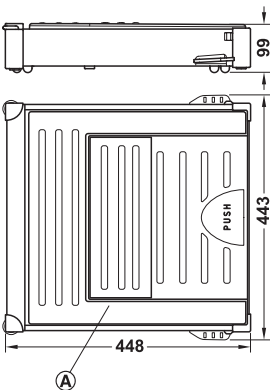

A

- Stored away beneath the cabinet which saves space
- Can easily be lifted and lowered by gently stepping on it
- Rollers provide easy movement in any direction

- Material: Steel, steps: Plastic
- Version: With 2 steps, with non-slip surface, rollers rotate through 360°, with self-locking action
- Load bearing capacity: 150 kg
- Installation: In plinth area 100 mm and 120 – 150 mm
- Height: 460 mm in lifted position, 99 mm in folded position

Supplied with

- 1 Step ladder **A**
- 1 Installation frame **B**
- 1 Hinge for folding plinth 120 – 150 mm **C**
- 1 Adapter for plinth 100 mm **D**
- 1 Set of installation and operating instructions

Colour	Cat. No.
Black	505.07.052

Packing: 1 piece

Application

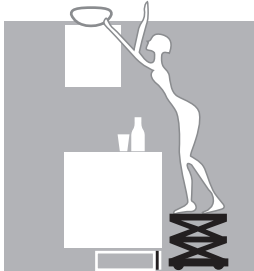

Broomstick holder

→ Single (also for set extension)



Note

Can be slid in (variably) triple rail.

- Area of application: For broomstick thicknesses from 23 – 28 mm
- Material: Holder: Steel, rollers: Rubber
- Finish: Holder: Galvanized/Delta Seal coated (rustproof)
- Dim. (W x D x H): 51 x 40 x 50 mm
- Installation: For screw fixing

Version	Cat. No.
Rust proof (10 year manufacturer's guarantee) Spring steel thickness: 0.5 mm	520.10.008
Standard Spring steel thickness: 0.5 mm	520.10.009
Reinforced Spring steel thickness: 0.8 mm	520.10.010

Packing: 1 or 50 pieces

→ Triple (fixed)

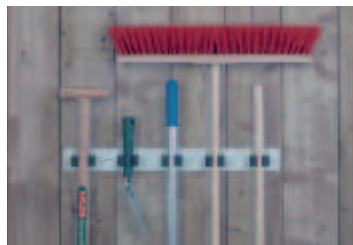
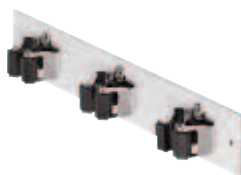

- Area of application: For broomstick thicknesses from 23 – 28 mm
- Material: Holder: Steel, rollers: Rubber, rack: MDF
- Finish: Holder: Galvanized, polished, rack: Plastic coated white
- Installation: For screw fixing

Version	Dim. (W x D x H) mm	Cat. No.
3 holders	330 x 58 x 60	520.10.741
4 holders	440 x 58 x 60	520.10.752
5 holders	550 x 58 x 60	520.10.764

Packing: 1 piece

→ Triple (variable)

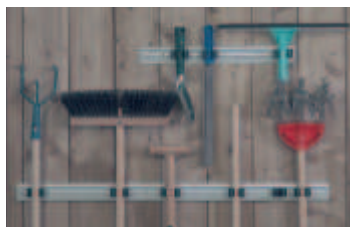
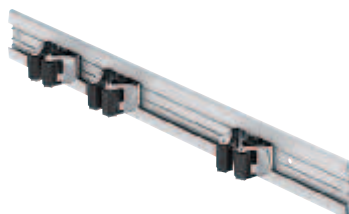

- Area of application: For broomstick thicknesses from 23 – 28 mm
- Material: Holder: Steel, rollers: Rubber, rack: Aluminium
- Finish: Holder: Galvanized, polished, rack: Silver coloured anodized
- Installation: For screw fixing

Dim. (W x D x H) mm	Cat. No.
480 x 50 x 55	520.10.913

Note

Further broomstick holders can be added. The racks can be mounted end to end without gap.

Packing: 1 piece

→ Quadruple



- Material: Housing: Plastic, hooks: Steel
- Finish: Housing: White, hooks: Rubber covered
- Installation: For concealed screw fixing
- Supplied with: Fixing material

Dim. (W x D x H) mm	Cat. No.
318 x 27 x 75	520.44.700

Packing: 1 piece

Single waste bin

5 litres

Vitaflex

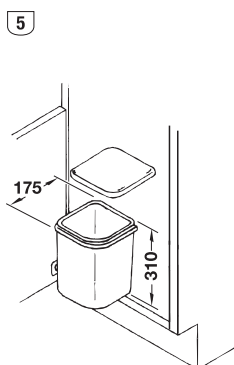

- For cabinet width: min. 300 mm
- For internal cabinet depth: min. 192 mm
- Installation: For screw fixing to cabinet door
- Mounting: For left and right hand use

Capacity l	Material	Cat. No.
5	Plastic, white	502.63.726

Packing: 1 piece

5 litres

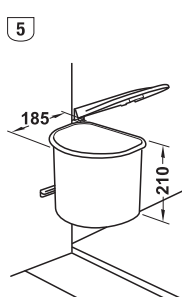

- For cabinet width: min. 300 mm
- For internal cabinet depth: ≥210 mm
- Installation: For screw fixing to cabinet door
- Mounting: For left hand and right hand use

Capacity l	Material	Cat. No.
5	Plastic, white	502.00.741

Packing: 1 piece

11 litres

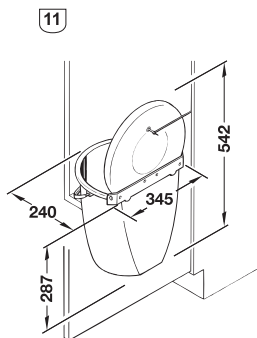

- For cabinet width: min. 400 mm
- Installation height: min. 340 mm
- Installation: For screw fixing to cabinet door
- Mounting: For left and right hand use

Capacity l	Material	Cat. No.
11	Bin, bin holder and lid: Plastic, white Fixing eye: Steel	500.07.746

Packing: 1 or 60 pieces

13 litres

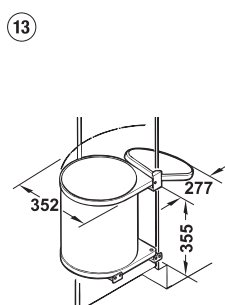

- For cabinet width: min. 400 mm
- Installation: For screw fixing to side panel
- Mounting: For left and right hand use

Capacity l	Material	Cat. No.
13	Plastic, white Bin: Plastic, grey	502.01.713
	Plastic, silver coloured Bin: Plastic, grey	502.01.923

Packing: 1 piece

