

→ Solid wood, triple laminated

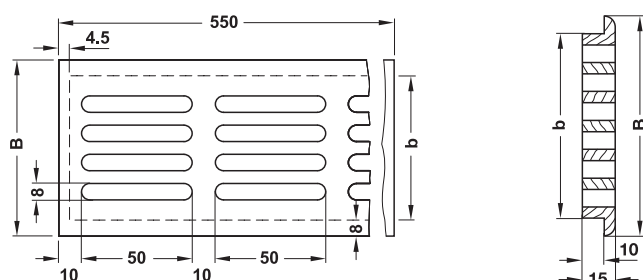
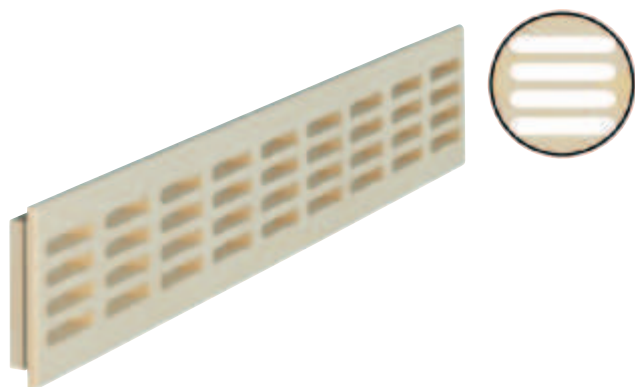

- Finish: Natural, finely sanded
- Version: Triple laminated, temperature and water resistant, top layer made from one piece, long edges rebated and rounded
- Installation: For recess mounting
- Aperture: 50 x 8 mm

Technical data

Width B mm	80	100	120
Dim. b	64	84	104
Ventilation cm ²	135	202	236

Material	Width B 80 mm	Width B 100 mm	Width B 120 mm
Maple	574.04.124	574.04.134	574.04.144
Beech	574.04.324	574.04.334	574.04.344
Oak	574.04.424	574.04.434	574.04.444
Spruce	574.04.824	574.04.834	574.04.844
Cherry	574.04.624	—	574.04.644

Packing: 1 piece

Decorative grills made of wood

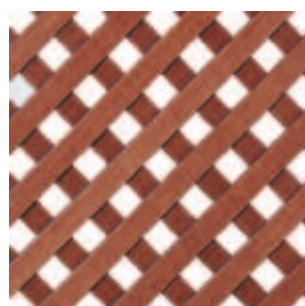

Slat running direction 45°

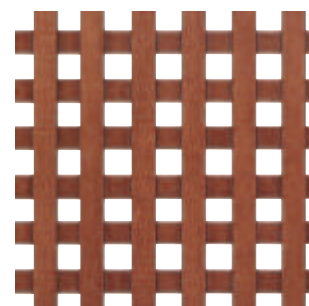

Slat running direction 90°

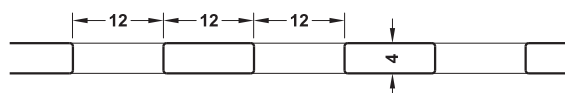

Section lengthways

- Area of application: For door panels, Spanish partitions, decorative radiator panelling or ventilation openings
- Finish: Slats: Shaped and sanded, grill: Can be varnished
- Dim.: 1,200 x 600 mm or special version
- Thickness: 4 mm
- Version: With slats that are rounded at both sides

Material	Cat. No.
Slat running direction 45°	
Spruce	574.91.802
Beech	574.91.302
Oak	574.91.402
Maple	574.91.102
Slat running direction 90°	
Spruce	574.91.812
Beech	574.91.312
Oak	574.91.412
Maple	574.91.112
Special version	
Please specify the following when ordering:	574.91.999
• Type of wood (maple, beech, oak, alder, spruce or cherry wood)	
• Length (≤2400 mm)	
• Width (≤900 mm)	
• Slat running direction (45° or 90°)	

Packing: 1 piece

Hotel Mini bar

→ Gross capacity 30 litres



- Area of application: Free standing or built-in
- Dim. (W x D x H): 441 x 457 x 511 mm
- Material: Steel
- Finish/colour: Plastic coated, Black
- Mains voltage: 230 V, 50-60 Hz
- Wattage: 60-75 W
- Mounting: For left and right hand use
- Version: With interior LED lighting, absorption refrigeration, automatic defrost

Version	Energy efficiency class	Energy consumption	Weight kg	Cat. No.
Standard door	D	0.728 kWh/24 h	13.4	536.14.000
Glass door	F	1.019 kWh/24 h	15.6	536.14.001

Packing: 1 piece

6

Refrigerators

→ Gross capacity 40 litres



- Area of application: Free standing or built-in
- Dim. (W x D x H): 441 x 457 x 566 mm
- Material: Steel
- Finish/colour: Plastic coated, Black
- Mains voltage: 230 V, 50-60 Hz
- Wattage: 60-75 W
- Mounting: For left and right hand use
- Version: With interior LED lighting, absorption refrigeration, automatic defrost, fridge door shelf for 1.5 litre bottles

Version	Energy efficiency class	Energy consumption	Weight kg	Cat. No.
Standard door	E	0.843 kWh/24 h	14.5	536.14.010
Glass door	F	1.019 kWh/24 h	16.7	536.14.011

Packing: 1 piece

Connecting fitting for appliance doors



- Area of application: For connecting the built-in refrigerator door with the completely mounted furniture door
- Material: Plastic

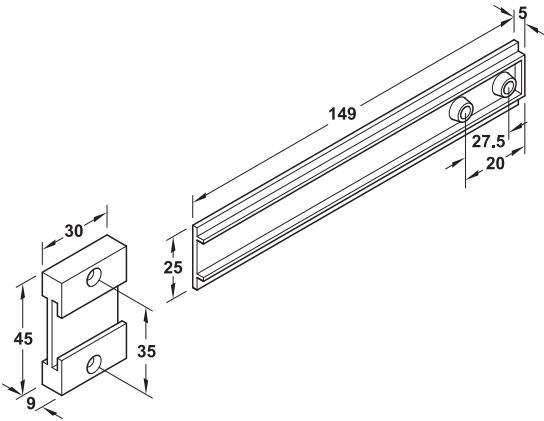

Installation

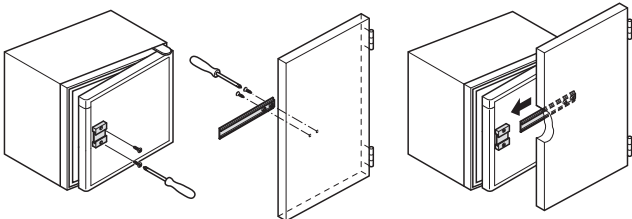

- Screw guide to the outside of the refrigerator door.
- Open refrigerator door by 90°.
- Screw rail horizontally onto the inside of the furniture door.
- Slide rail into guide.

Supplied with

- 1 Connecting fitting for appliance doors
- 4 Fixing screws

Colour	Cat. No.
Brown	568.16.007

Packing: 1 or 10 pieces

Protection rails

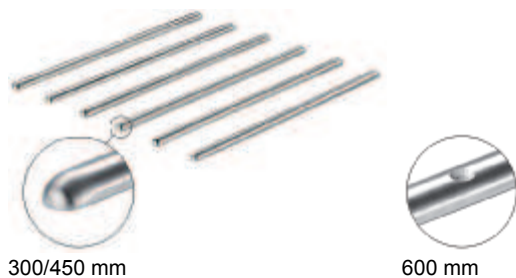

300/450 mm

600 mm

- Area of application: For worktops and furniture made from oiled wood, laminate, glass, granite, stone, acrylic or slate
- Material: Zinc alloy
- Finish: Stainless steel coloured
- Version: Resistant against heat (up to 200 °C) and moisture
- Dimensions (W x H): 13 x 7 mm

Supplied with

1 Set consisting of 6 protection rails

→ Protection rails for worktops



Length mm	Installation	Cat. No.
300	Self-adhesive	808.90.090

Packing: 1 set

→ Protection rails for furniture



Length mm	Installation	Cat. No.
450	Self-adhesive	808.90.091
600	For screw fixing	808.90.084

Packing: 1 set

Order reference

Please order screws for length 600 mm separately.

Chipboard screw with PZ countersunk head, length 15 mm ► FF 13.17

Protective foil, heat reflecting

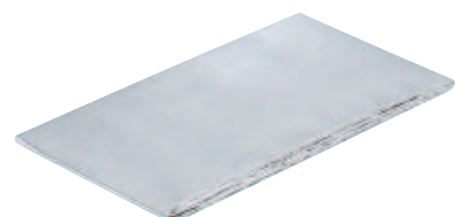

- Area of application: For protecting the worktop underside from radiant heat rising from dishwashers or hobs and to stop moisture penetrating the worktop underside which could lead to expansion
- Material: Aluminium
- Version: Heat reflecting
- Installation: Self-adhesive
- Foil thickness: 0.1 mm

Dim. (L x W) mm	Cat. No.
1000 x 600	547.92.980

Packing: 1 piece



6

Kitchen Cabinet Construction

→ For press fitting and screw fixing, load bearing capacity 130 kg/pair



- Material: Cabinet hanger: Steel
- Finish: Galvanized
- Adjustment facility: Adjustment screws can be accessed from the front after installation
- Cabinet hanger is mounted "invisibly" behind the rear panel (space requirement min. 16 mm)

Installation

- For safety reasons, the cabinet hanger must be fitted in the upper third of the cabinet.
- If under extreme loads: Mount at least 2 screws with countersunk head (3.5 x 30 mm). Screw must rest on dowel.

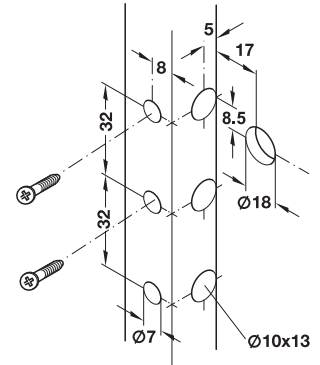

For press fitting

Quick fixing system with lever

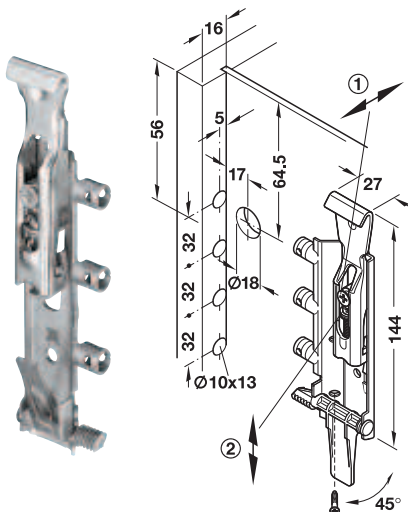

Mounting left

Mounting right



Mounting left

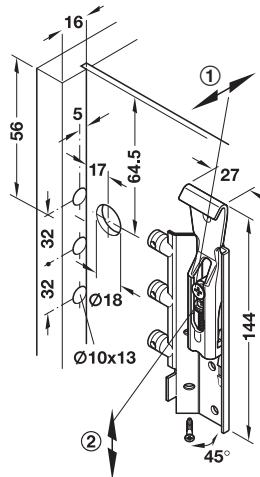

Mounting right



For screw fixing

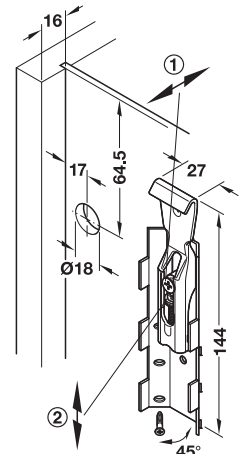

Mounting right

- ① Depth setting with clearance 20 mm
- ② Height settings 18 mm

Installation		Mounting	Cat. No.
For press fitting	Quick fixing system with lever	Left	290.21.901
		Right	290.21.900
	Quick fixing system with screw	Left	290.21.911
		Right	290.21.910
For screw fixing, right and left		Left or right	290.21.930

Packing: 20 or 100 pieces

→ **Cover cap**

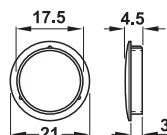

Material	Finish	Cat. No.
Zinc alloy	Nickel plated	290.21.690

Packing: 100 or 1000 pieces

Wall rail

► FF 6.130

→ For press fitting, load bearing capacity 130 kg/pair

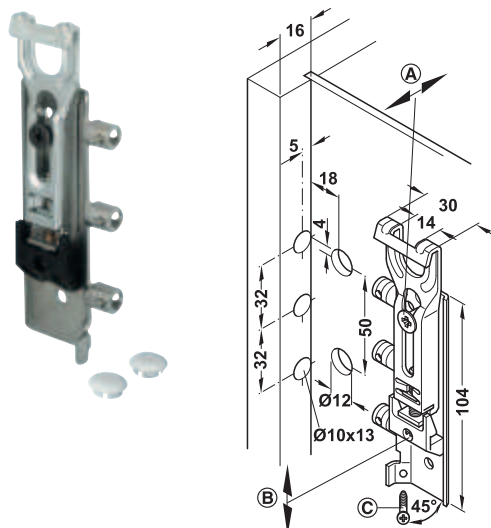

- A** Depth adjustment: From 15 – 21 mm with clearance 16 mm
B Height adjustment: Height 15 mm
C Safety lock screw

- Material: Steel, cover caps: Plastic
- Finish/colour: Galvanized, cover caps: White, RAL 9010
- Adjustment facility: Height 15 mm, depth max. 21 mm, side approx. 8 mm (with screw hook), max. 16 mm (with wall rail)
- Height and depth adjustment with Ø 12 mm drill holes in rear panel, adjusting screws can be accessed from the front after installation
- Cabinet hanger is mounted "invisibly" behind the rear panel (space requirement min. 16 mm)

Note

- For safety reasons, the cabinet hanger must be fitted in the upper third of the cabinet.
- Screw in safety lock screw at an angle of 45°.
- If under extreme loads: Mount at least 2 screws with countersunk head (3.5 x 30 mm). Screw must rest on dowel.

Mounting	Cat. No.
Left	290.03.921
Right	290.03.920

Packing: 1 or 20 pieces

6

Cabinet hanger with hook-off protection device

→ For press fitting or screw fixing, load bearing capacity 130 kg/pair

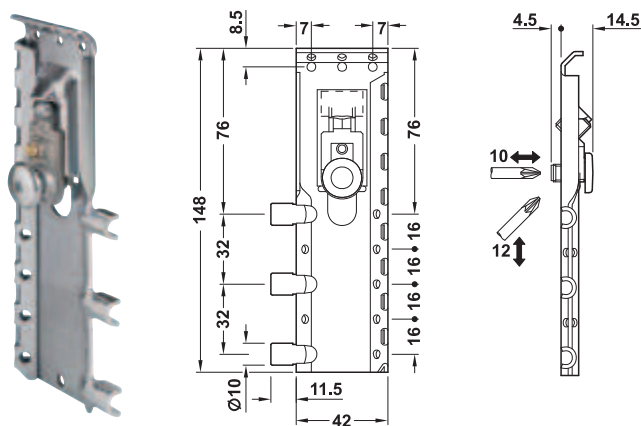

- Material: Steel
- Finish: Galvanized
- Adjustment facility: Height: 12 mm, depth: 10 mm
- Installation: Mounted invisibly behind the rear panel

Note

For safety reasons, the cabinet hanger must be fitted in the upper third of the cabinet.

Mounting	Cat. No.
Left	290.04.911
Right	290.04.910

Packing: 20 pieces

Order reference

Hook-off protection device can only be used in combination with cabinet hanger and wall plate. Please order support plate separately.

Wall plate for cabinet hanger ► FF 6.127

→ Cover cap

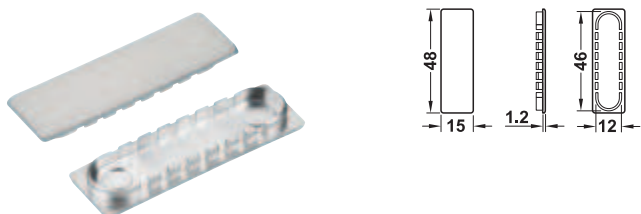

- Material: Plastic

Colour	Cat. No.
White	290.21.795
Nickel coloured	290.21.695

Packing: 20 pieces

→ Wall plate for cabinet hanger with hook-off protection device

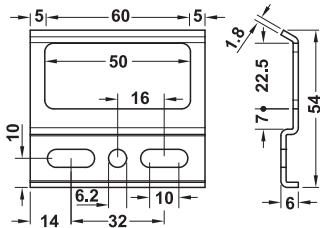
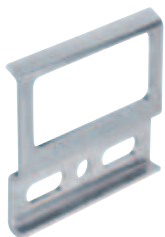

- Material: Steel
- Finish: Galvanized

Dim. mm	Cat. No.
60 x 54 x 6	290.21.993

Packing: 20 pieces

Visible inside the cabinet

→ For press fitting, load bearing capacity 130 kg/pair

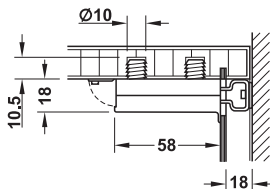
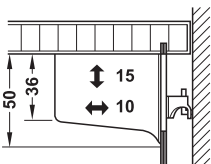

- Material: Plastic
- Colour: White
- Adjustment facility: Height 15 mm, depth 15 mm, side 10 mm

Mounting	Cat. No.
Left	290.31.711
Right	290.31.710

Packing: 1 or 200 pieces

Installation

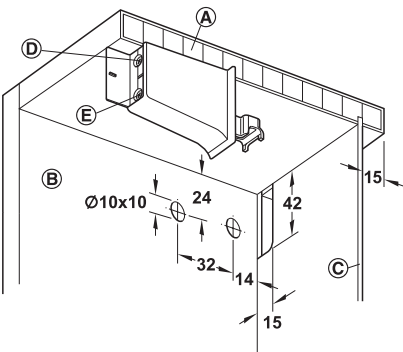

- Ⓐ Cabinet top panel
- Ⓑ Side panel
- Ⓒ Rear panel
- Ⓓ Height adjustment
- Ⓔ Depth adjustment

For screw fixing

→ Load bearing capacity 90 kg/pair

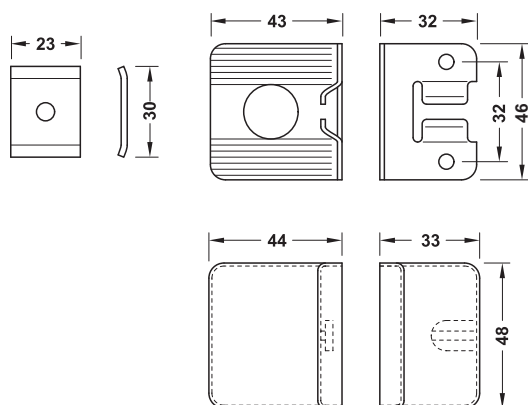
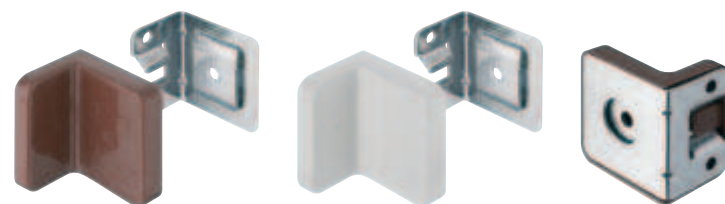

- Material: Cabinet hanger: Steel, cover cap: Plastic
- Finish: Galvanized
- Adjustment facility: Height 8 mm, depth 8 mm
- Mounting: Can be used on the left, right or in the middle

Version	Cat. No.
Cover cap brown	290.34.100
Cover cap white	290.34.700

Packing: 1 or 300 pieces

Note
Please use round head screws for wall mounting.



6

→ Load bearing capacity 100 kg/pair

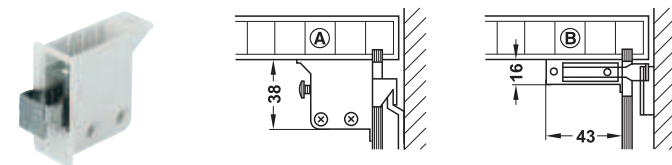

Installation

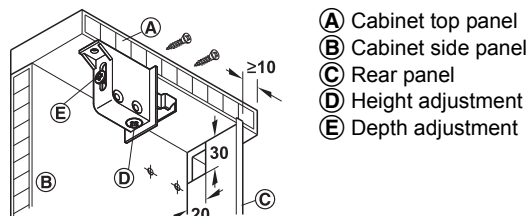

- Ⓐ Cabinet top panel
- Ⓑ Cabinet side panel
- Ⓒ Rear panel
- Ⓓ Height adjustment
- Ⓔ Depth adjustment

- Material: Plastic
- Mounting: Can be used on the left, right or in the middle
- Adjustment facility: Height 16 mm, depth 6 mm, side 5 mm

Colour	Cat. No.
White, RAL 9010	290.00.720
White aluminium, RAL 9006	290.00.220
White, RAL 9001	290.00.725

Packing: 100 pieces



→ Load bearing capacity 130 kg/pair

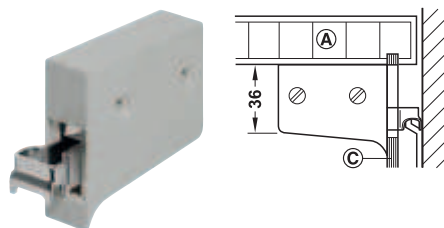

- Material: Plastic
- Adjustment facility: Height 15 mm, depth 10 mm
- Mounting: Left or right

Installation

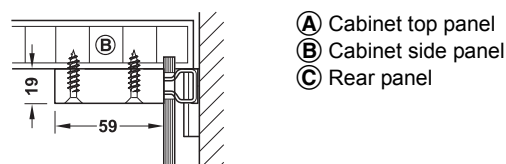

- Ⓐ Cabinet top panel
- Ⓑ Cabinet side panel
- Ⓒ Rear panel

Colour	Cat. No.
White	290.05.740

Packing: 20 pieces

Wall rail	► FF 6.130
Wall plate	► FF 6.131

→ Load bearing capacity 90 kg/pair



Cabinet hanger



Cover cap

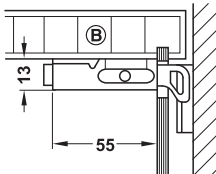
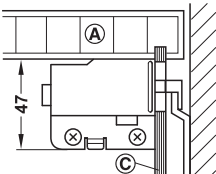

Installation

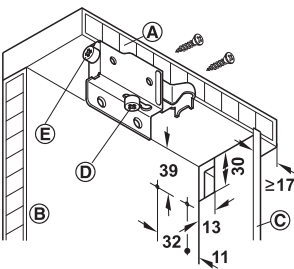

- Ⓐ Cabinet top panel
- Ⓑ Cabinet side panel
- Ⓒ Rear panel
- Ⓓ Height adjustment
- Ⓔ Depth adjustment



- Material: Cabinet hanger: Steel, cover cap: Plastic
- Adjustment facility: Height 16 mm, depth 14 mm, side 5 mm

Finish/colour	Mounting left	Mounting right
Cabinet hanger		
Galvanized	290.02.711	290.02.710
Cover cap		
Brown, RAL 8011	290.02.191	290.02.190
Beige, RAL 1011	290.02.481	290.02.480
Ivory coloured, RAL 1015	290.02.491	290.02.490
White, RAL 9010	290.02.781	290.02.780

Packing: 20 or 200 pieces

→ Load bearing capacity 150 kg/pair

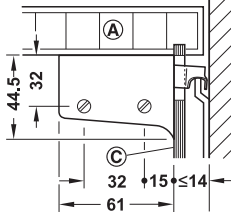
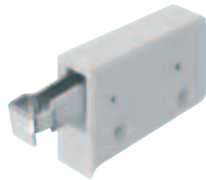

- Ⓐ Cabinet top panel
- Ⓒ Rear panel

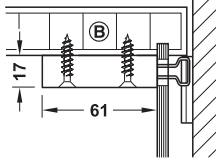

- Ⓑ Cabinet side panel



- Material: Plastic
- Mounting: Can be used on the left, right or in the middle

Colour	Cat. No.
White	290.00.740

Packing: 100 pieces

Wall rail	► FF 6.130
Wall plate	► FF 6.131

→ Load bearing capacity 200 kg/pair

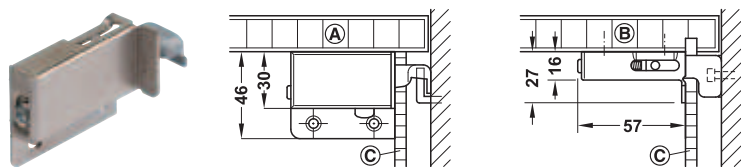

- Material: Steel
- Finish: Nickel plated
- Adjustment facility: Height 16 mm, depth 15 mm, side 10 mm

Installation

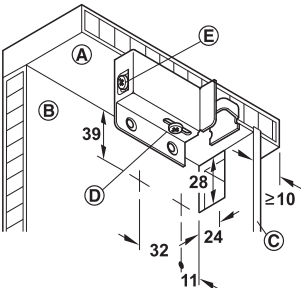

- (A) Cabinet top panel
- (B) Cabinet side panel
- (C) Rear panel
- (D) Height adjustment
- (E) Depth adjustment



Mounting	Cat. No.
Left	290.02.701
Right	290.02.700

Packing: 20 pieces



Wall rails
For cabinet hangers

- Material: Steel
- Finish: Galvanized
- Installation: For screw fixing

→ Length 1,250 mm

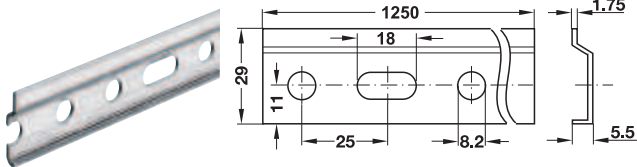

Length mm	Cat. No.
1250	290.09.910

Packing: 1 or 10 pieces

Order reference
Fixed lengths available on request.
Minimum order quantity: 100 pieces

→ Length 2,032 mm

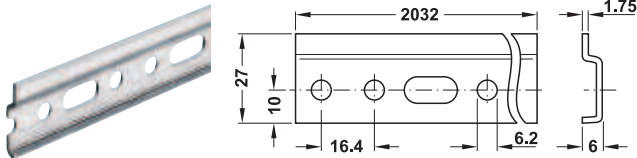

Length mm	Cat. No.
2032	290.10.900

Packing: 1 piece

Wall plates

For cabinet hangers

- Material: Steel
- Finish: Galvanized
- Installation: For screw fixing

→ Length 60 mm

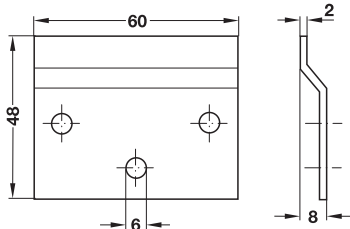

Length mm	Cat. No.
60	290.08.900

Packing: 20 or 200 pieces

→ Length 63 mm

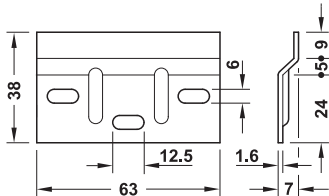

Length mm	Cat. No.
63	290.08.920

Packing: 1 or 100 pieces



6

→ Length 80 mm

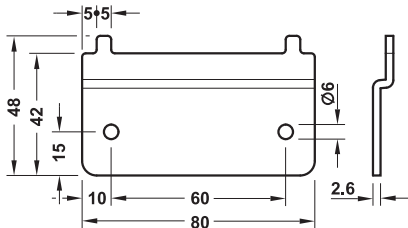

Length mm	Cat. No.
80	290.08.952

Packing: 20 or 200 pieces

→ Length 110 mm, can be cut to size

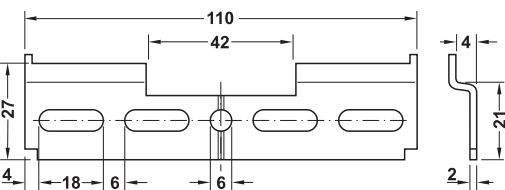

Length mm	Cat. No.
110	290.21.992

Packing: 20 pieces

Cabinet hanger for base unit

For press fitting, load bearing capacity 240 kg/pair

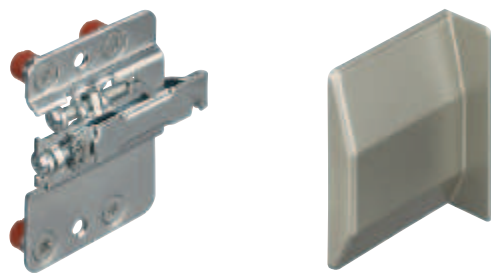

Cabinet hanger
for base unit left

Cover cap right

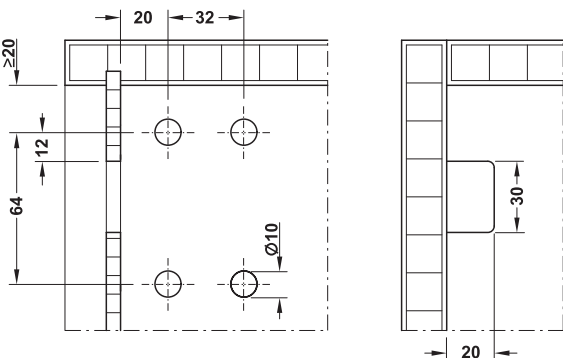
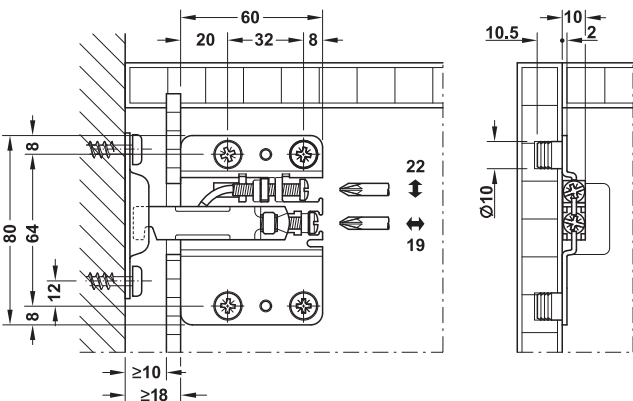

- Material: Cabinet hanger for base unit: Steel, cover cap: Plastic
- Adjustment facility: Height: 22 mm, depth: 19 mm

Finish/colour	Mounting left	Mounting right
Base unit cabinet hanger		
Galvanized	290.40.902	290.40.901
Cover cap		
White	290.40.702	290.40.701
Nickel coloured	290.40.602	290.40.601

Packing: 1 or 20 pieces

Mounting tool

Area of application	Cat. No.
For press fitting the cabinet hanger into side panel	290.40.999

Packing: 1 piece

Wall plate with hook-off protection device

For cabinet hangers for base unit

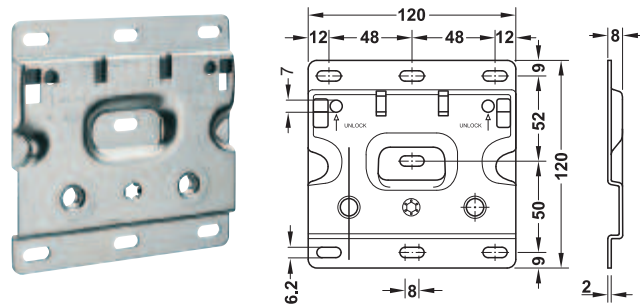

Length 120 mm

Installation

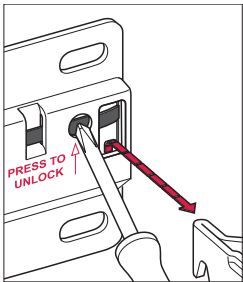

Hook-off protection device prevents unintentional unhooking of the wall unit.

- Material: Steel
- Finish: Galvanized

Length mm	Version	Cat. No.
120	Multiple screw-on positions	290.40.991

Packing: 1 or 20 pieces



Lift systems for barrier-free living to suit any lifestyle

Vitaflex



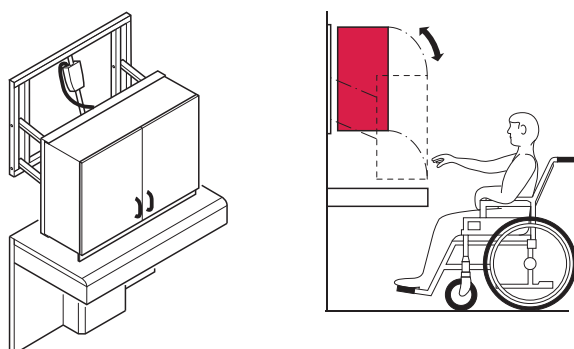

Your furniture can be adapted to individual requirements using lift systems.

Wall unit lift

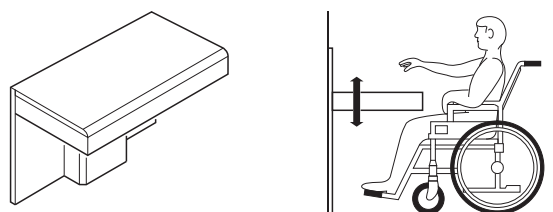

The wall unit lift makes individual, continuously variable height adjustment possible. The diagonal mechanism moves the lift forward when it is lowered.

Worktop lift



The worktop lift allows any user to move the worktop to their own personal working height.

Internal cabinet lift

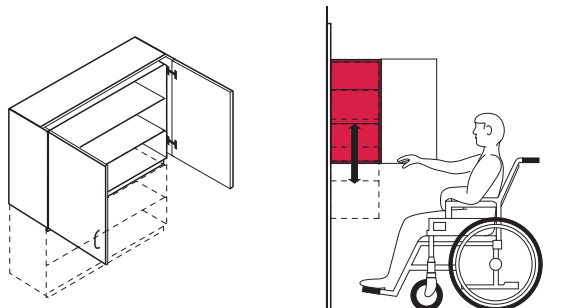

The internal cabinet lift makes continuously variable shelf height adjustment possible. The shelves that are attached to the lift can be moved vertically downwards.

Safety stop for wall units

An automatic safety stop plate is supplied with all wall unit lifts.

Safety stop for worktop lifts

All worktop lifts have an automatic safety stop plate at the front edge as standard.

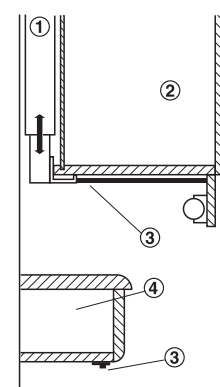

- ① Lifting leg
- ② Wall unit
- ③ Safety stop
- ④ Worktop

Wall unit lift

Vitaflex



- Area of application: For wall units with a height of 700 – 1,100 mm
- Material: Frame: Steel, control unit and sockets: Plastic
- Finish: Frame: Lacquered
- Colour: Frame: Silver coloured, control unit and sockets: Grey
- Functionality: The cabinet is moved diagonally downwards forward, control with push button, the automatic safety stop plate stops the downward movement by a gentle push
- Travel: 435 mm vertically
- Travel speed: 1.7 cm/s
- Load bearing capacity: 150 kg (including top unit)
- Installation: For screw fixing to the wall
- Mains voltage: 230 V, 50 Hz

Supplied with

- 1 Lift system (without wall unit)
- 2 Fixing brackets for wall unit
- 1 Automatic safety stop plate
- 1 Built-in push button



For cabinet width mm	Dim. B mm	Cat. No.
600	550	506.03.106
900	550	506.03.109
1200	1150	506.03.112
1800	1150	506.03.117

Packing: 1 piece

Order reference

Operation with radio or infrared remote control.
Other dimensions available on request.



6

Lift Systems

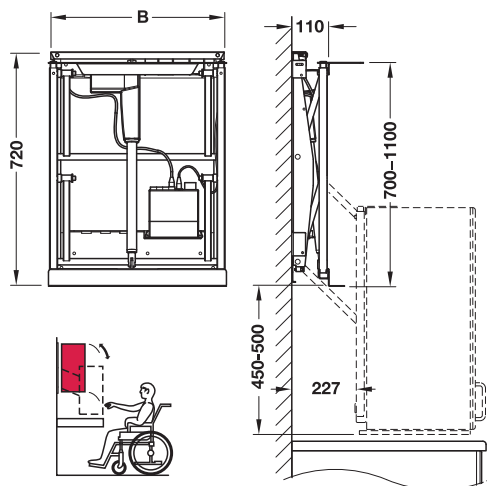

→ Roller blind



- Colour: Fabric: Grey

For cabinet width mm	Width B mm	Cat. No.
600	550	506.03.990
1200	1150	506.03.992

Packing: 1 piece

Internal cabinet lift

Vitaflex

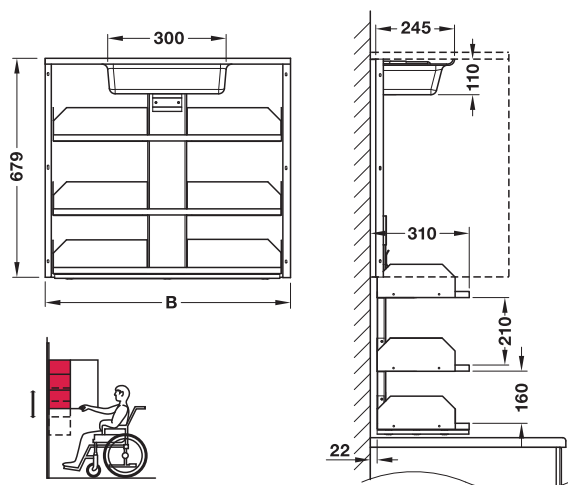

- Area of application: For wall units with a height from 700 mm and above
- Material: Lifting column: Aluminium, cover: Plastic, lateral plate: Steel
- Finish: Lifting column: Bright, lateral plates: Lacquered
- Colour: cover: White, lateral plates: Silver coloured, shelves: White
- Functionality: The lift moves the shelves downwards out of the cabinet, control with push button, the automatic safety stop plate stops the downward movement by a gentle push 470 mm vertically
- Travel: 4.7 cm/s
- Load bearing capacity: 40 kg
- Installation: For screw fixing to the wall

Supplied with

- 1 Lift system (without wall unit)
- 1 Built-in push button
- 1 Transformer

CE

For cabinet width mm	Dim. B mm	Cat. No.
500	460	506.04.105
600	560	506.04.106
700	660	506.04.107
800	760	506.04.108
900	860	506.04.109
1000	960	506.04.110

Packing: 1 piece

Order reference

Operation with radio or infrared remote control available on request.

Lift, electric



► The latest product range can be found on the Internet at www.hafele.de or contact your sales office or your Häfele representative.

GAEB

CAD

6

Lift Systems

Worktop lift

Vitaflex

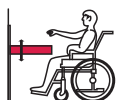
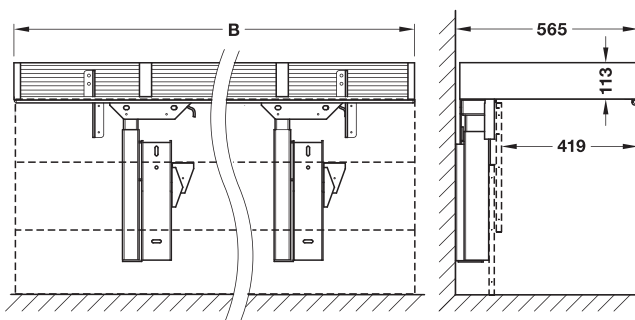
Note

Flexible hoses for water connections must be provided on site.

Order reference

Operation with radio or infrared remote control, worktop lift for corners and other dimensions available on request.

- Material: Aluminium
- Finish: Bright
- Colour: Frame: Silver coloured, control unit and sockets: Grey
- Functionality: For vertical movement of worktops, sinks, hobs, etc., drawers can be integrated, control with push button, the automatic safety stop plate stops the downward movement by a gentle push
- Dim.: Travel: 700 – 1,000 mm or 300 mm, lift width: 600 – 3,200 mm, frame height: 120 mm
- Travel speed: 1.5 cm/s
- Load bearing capacity: 100 kg
- Installation: For screw fixing to the wall
- Mains voltage: 230 V, 50 Hz

Supplied with

- 1 Lift system
- 1 Built-in push button
- 1 Set of installation instructions

CE

Installation width mm	Dim. B mm	Cat. No.
600	590	506.00.106
700	690	506.00.107
800	790	506.00.108
1000	990	506.00.110
1200	1190	506.00.112
1400	1390	506.00.114
1600	1590	506.00.116
1800	1790	506.00.118
2000	1990	506.00.120
2200	2190	506.00.122
2400	2390	506.00.124
2600	2590	506.00.126
2800	2790	506.00.128
3000	2990	506.00.130
3200	3190	506.00.132

Packing: 1 piece

Lift, electric

► The latest product range can be found on the Internet at www.hafele.de or contact your sales office or your Häfele representative.